

TOTAL EXTENT (AS PER PATTI) = 3720 Sq.M  
 ROAD AREA = 970 Sq.M  
 TOTAL No. OF PLOTS = 18 Nos.

**NOTE:**

1. SPLAY - 1.5M x 1.5M
2. MEASUREMENTS ARE INDICATED EXCLUDING SPLAY DIMENSIONS
3. ROAD AREA WAS ALREADY HANDED OVER TO THE LOCAL BODY  
 VIDE GIFT DEED DOC. NO.5163/2017, DATED:28.04.2017 @ SRO,AMBATTUR

**CONDITION:**

**DR RULE NO: 29 (11)**

THE COST OF LAYING IMPROVEMENTS TO THE SYSTEMS INRESPECT OF ROAD, WATER SUPPLY, SEWERAGE, DRAINAGE OR ELECTRIC POWER SUPPLY THAT MAY BE REQUIRED AS ASSESSED BY THE COMPETENT AUTHORITY, SHALL BE BORNE BY THE APPLICANT.

**LEGEND:**

- SITE BOUNDARY
- ROAD GIFTED TO LOCAL BODY
- EXISTING ROAD

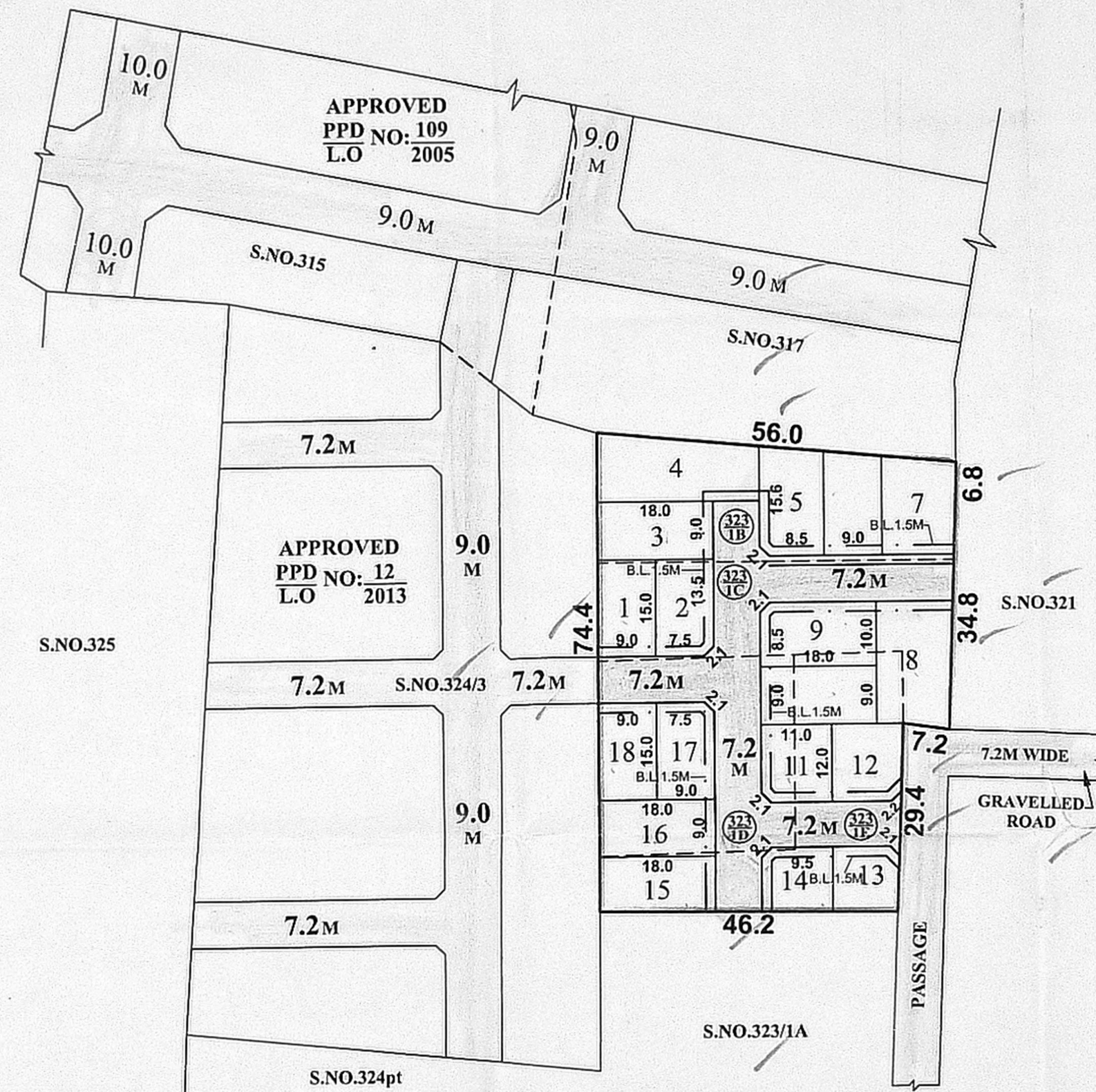

**CONDITIONS:**

THE LAYOUT APPROVED IS VALID SUBJECT TO OBTAINING SANCTION FROM THE LOCAL BODY CONCERNED.

P.P.D NO: 18  
 L.O NO: 2017  
**APPROVED**  
 VIDE LETTER NO : L1/17628/2016  
 DATE : 06/06/2017

*Signature*  
 06/06/2017  
 FOR MEMBER SECRETARY  
 CHENNAI METROPOLITAN  
 DEVELOPMENT AUTHORITY

*Signature*  
 PREPARED BY

*Signature*  
 P.A-I

*Signature*  
 A.P.(S.A) 06/06/2017

**VILLIVAKKAM PANCHAYAT UNION**

LAYOUT OF HOUSE SITES IN S.Nos: 323/1B, 1C, 1D, 1E OF AYAPAKKAM VILLAGE.

SCALE : 1:800 (ALL MEASUREMENTS ARE IN METRE)

